

PCB LAYOUT

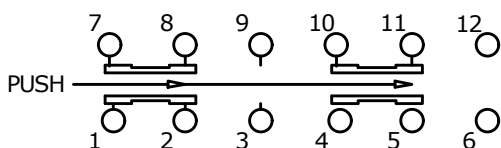

CIRCUIT DIAGRAM

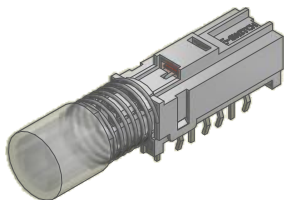
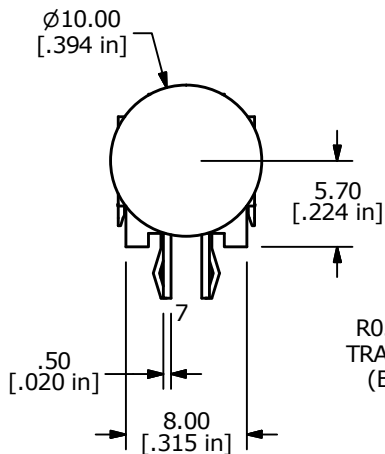
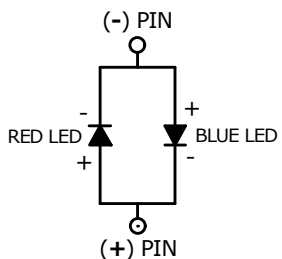

R05 BUTTON
TRANSPARENT
(B410000)

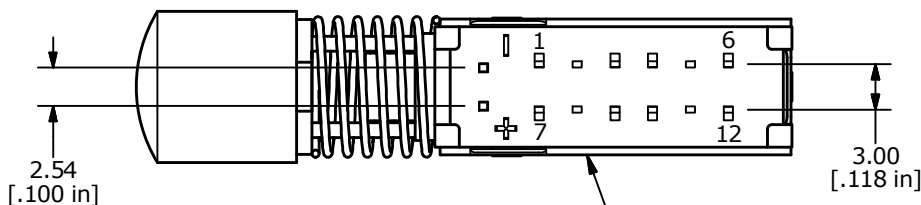
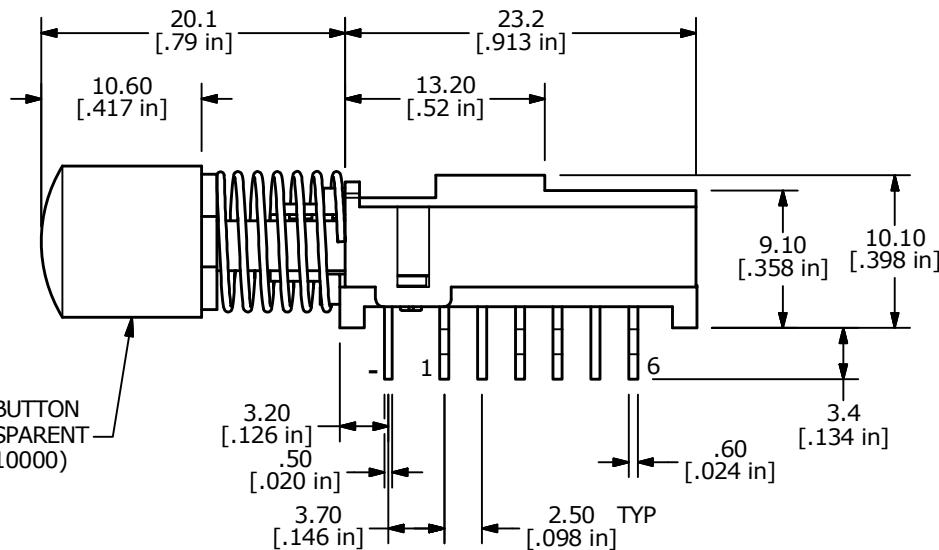
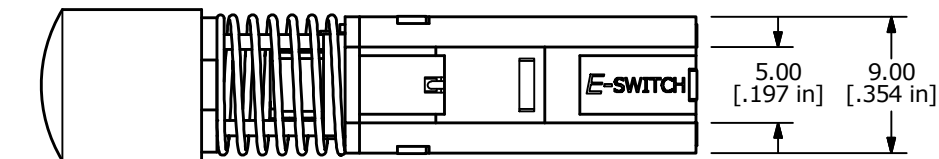

▲ WBL4UEERBQ
(B400012)

NOTES:

1. ALL DIMENSIONS IN MM [INCH]
2. GENERAL TOLERANCE: x.x = ± 0.4mm
x.xx = ± 0.25mm
3. RATING: DC 30V, 0.3A
4. OPERATING FORCE: 200 ± 100gf
5. TRAVEL: 3.3mm FULL TRAVEL
2.5mm TO LOCK
6. LIFE CYCLES: 10,000 CYCLES
7. OPERATING TEMPERATURE: -40°C to 85°C
8. CONTACT RESISTANCE: 20mΩ MAX.
9. INSULATION RESISTANCE: 100MΩ MIN@ 500VDC
- ▲ 10. LED COLOR: BICOLOR RED/BLUE
11. ▲ DENOTES CRITICAL PARAMETER.

LED SPECS	UNITS	RED	BLUE
FORWARD CURRENT	mA	20	20
FORWARD VOLTAGE @ 20mA	V	1.8 min - 2.6 Max	2.7 min - 3.5 Max
LUMINOUS INTENSITY @ 20mA	mcd	200 Typ	400 Typ



TITLE WBL4UEERBQR05CLR				
SCALE	DATE	DR	DWG	REV
2:1	12/18/2018	MW	XB0949P	A

A	23716	New-Release	12/19/18	MW
REV	PCR NO	DESCRIPTION	DATE	BY

THE INFORMATION CONTAINED IN THIS DOCUMENT IS PROPRIETARY TO E-SWITCH AND IS NOT TO BE COPIED OR TRANSFERRED